

BULOVA CORPORATE CENTER

75-20 ASTORIA BOULEVARD, QUEENS, NY 11370



BDG

BULOVA CORPORATE CENTER

75-20 ASTORIA BOULEVARD, QUEENS, NY 11370



AVAILABILITY

- 8,486 SF Suite 100
- 18,192 SF Suite 220
- 29,909 SF Suite 230
- 6,404 SF Suite 330

BUILDING INFORMATION

- Class A building
- On Site Parking
- Health Club
- Ping Pong Amenity
- Conference Center
- Excellent Highway Frontage
- 24 hour security
- 24/7 Public Transportation
- Access

FUTURE AVAILABILITY

AVAILABLE IN 1 YEAR:

- 7,000 SF First Floor

AVAILABLE IN 3 YEARS:

- 31,000 SF Second Floor
- 76,000 SF Third Floor

BUILDING USES

- Office
- Medical
- Retail



RADIUS



1 MILE
3 MILE
5 MILE

POPULATION



87,655
786,705
2,649,505

AVERAGE HOUSEHOLD INCOME



\$60,225
\$60,340
\$82,401

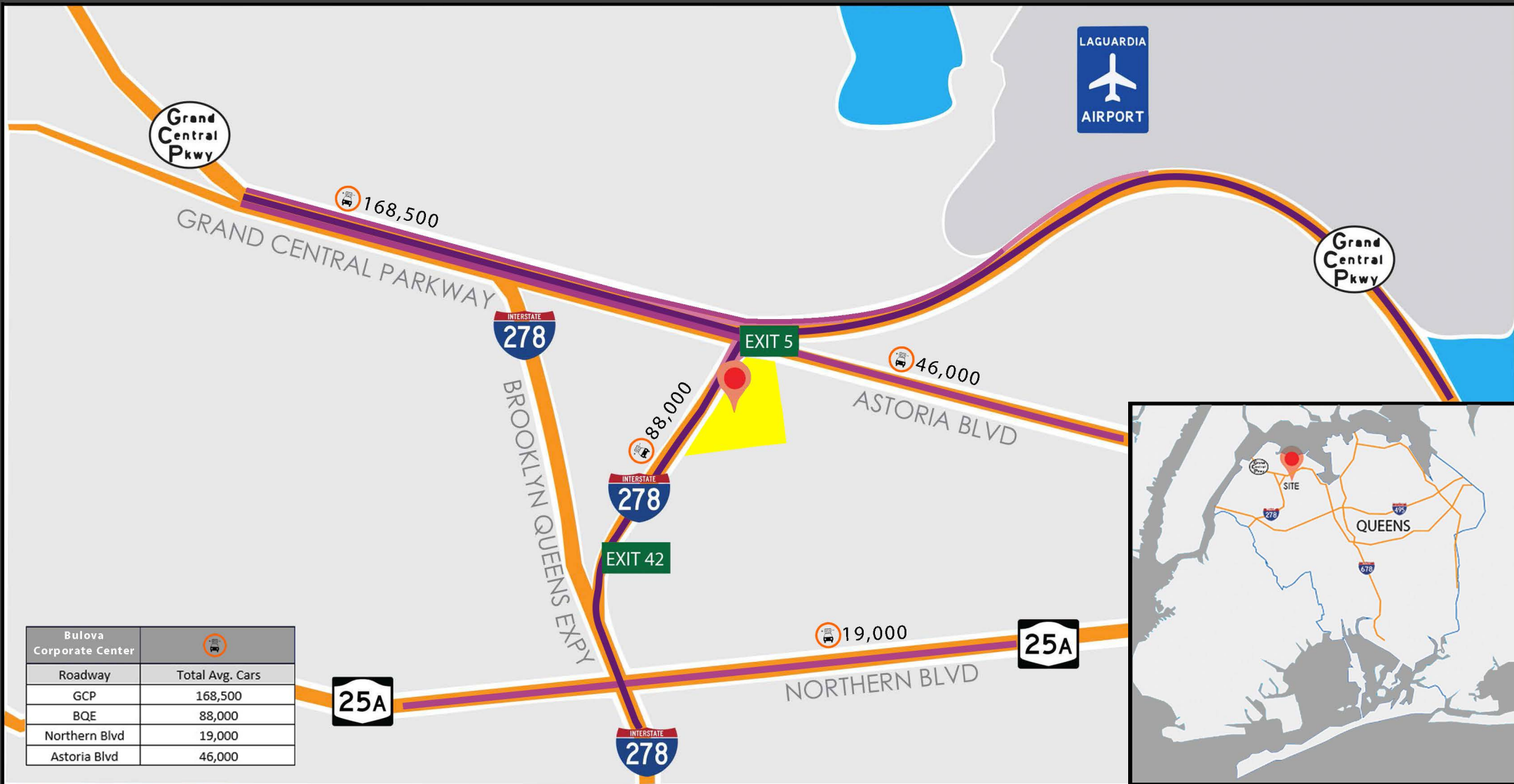

Bulova Corporate Center	
Roadway	Total Avg. Cars
GCP	168,500
BQE	88,000
Northern Blvd	19,000
Astoria Blvd	46,000



500,000 SF
CLASS A BUILDING

DENSE
MARKET



786,705 PEOPLE
IN A 3-MILE
RADIUS



HIGHWAY
ACCESS ON BQE



 **BULOVA CORPORATE CENTER**

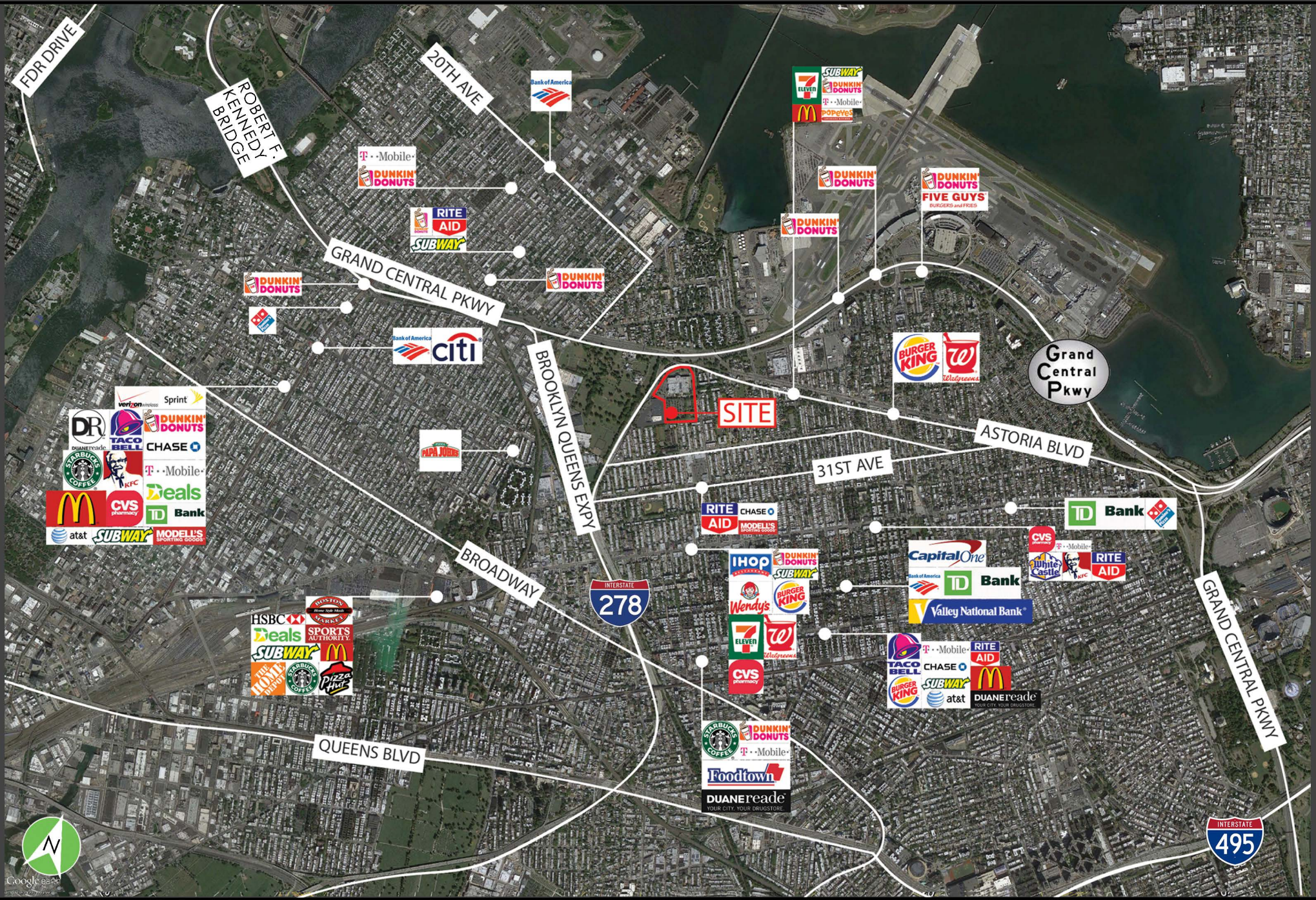

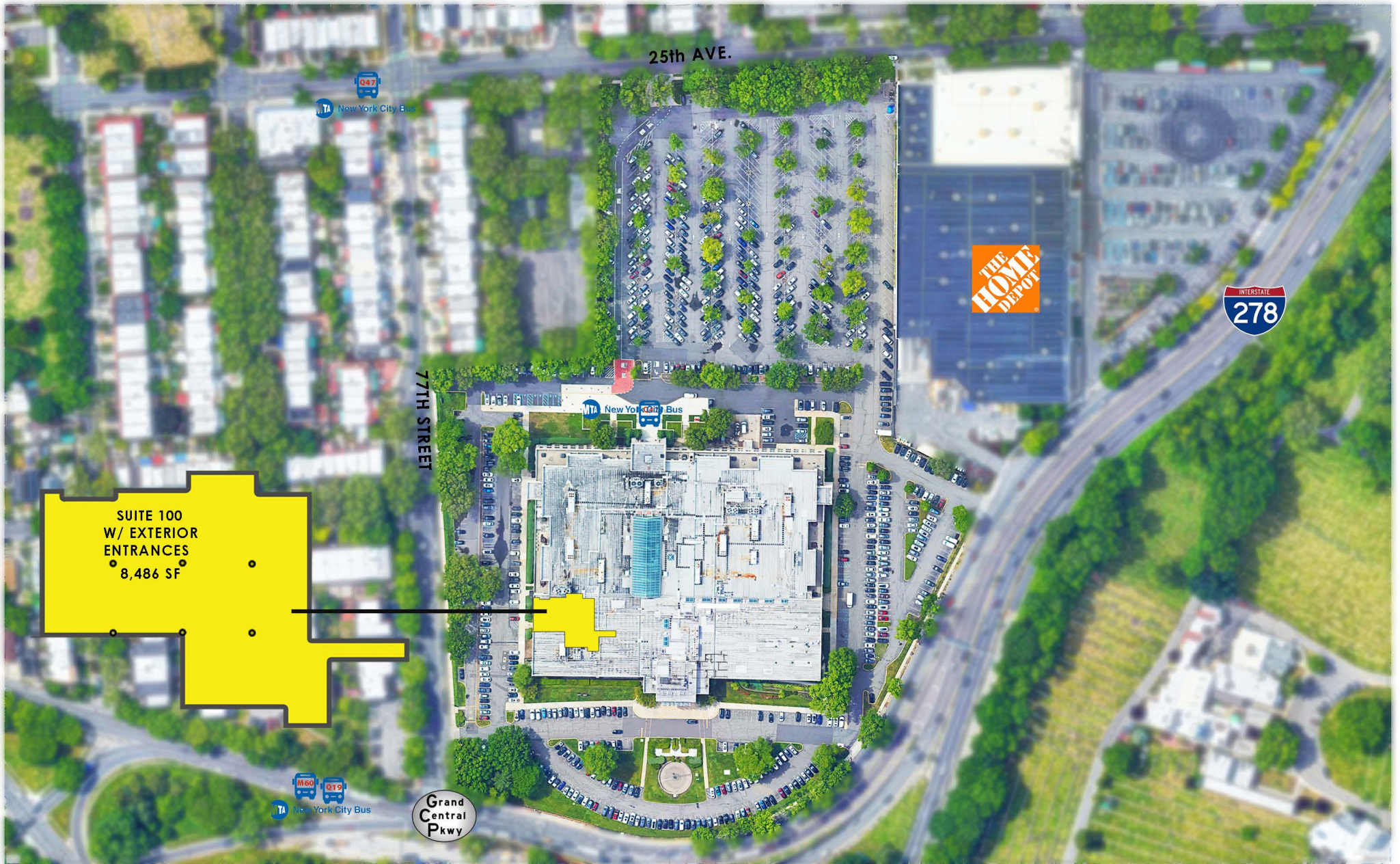

FIRST FLOOR



BULOVA CORPORATE CENTER

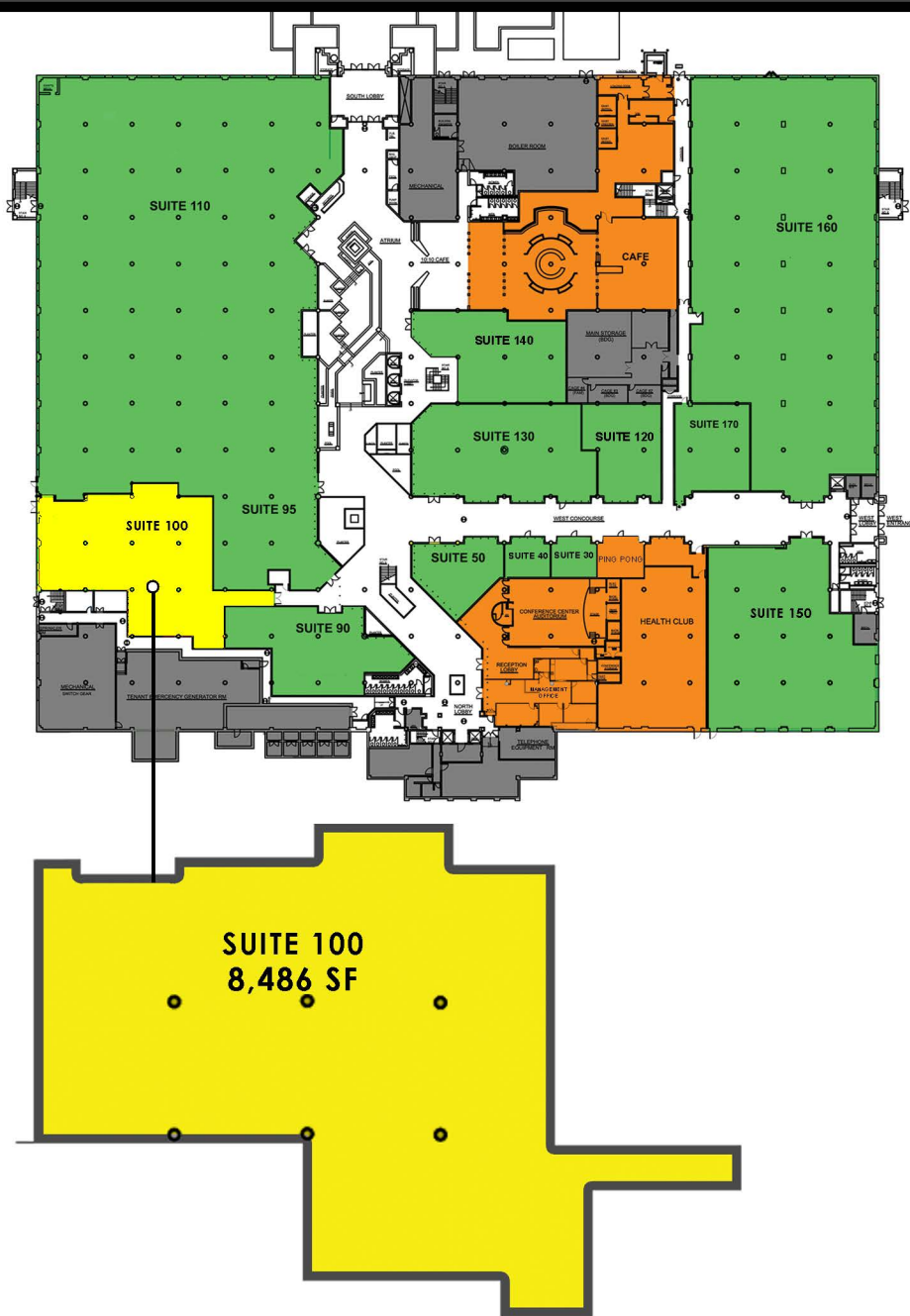

FIRST FLOOR



BULOVA CORPORATE CENTER

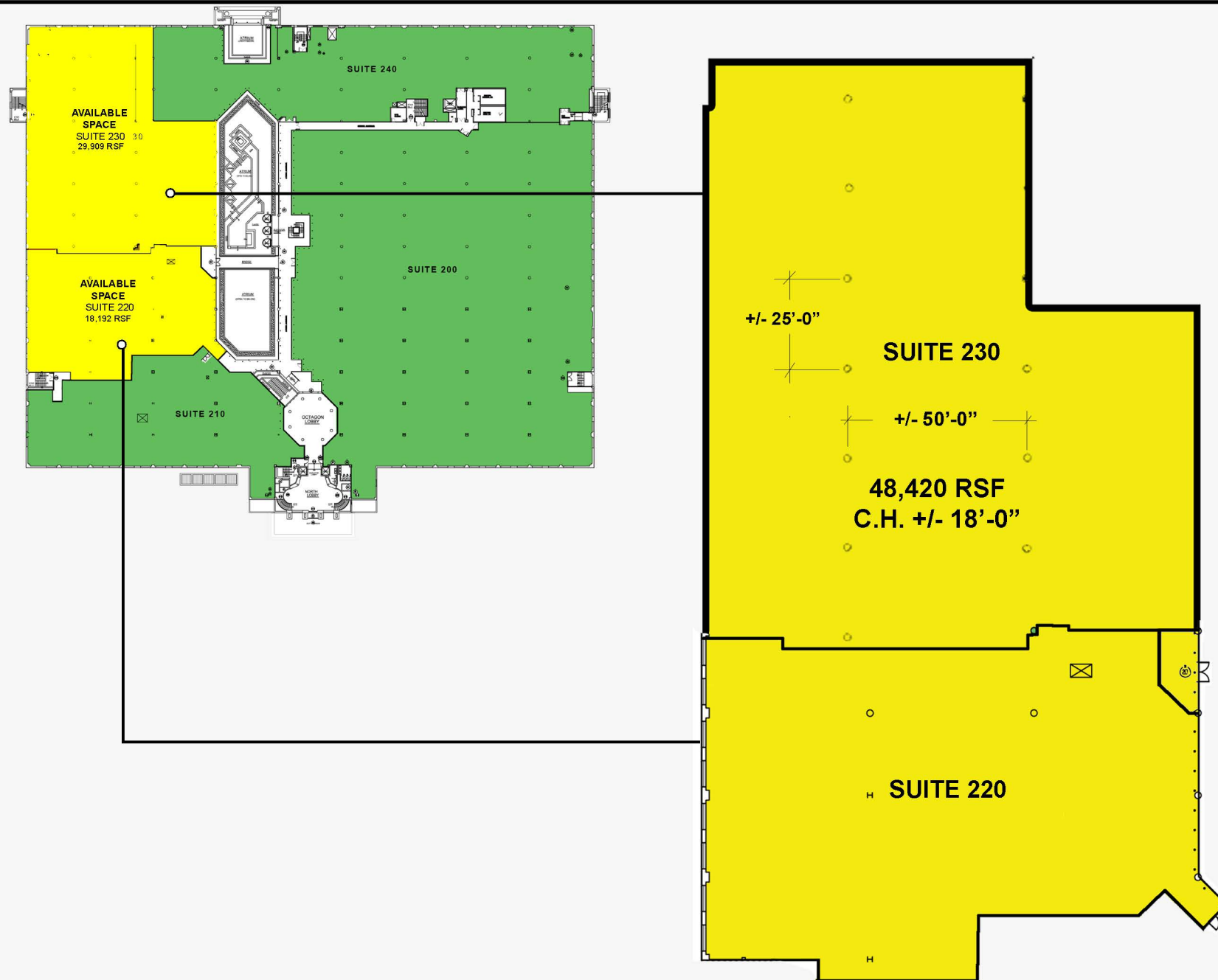

SECOND FLOOR

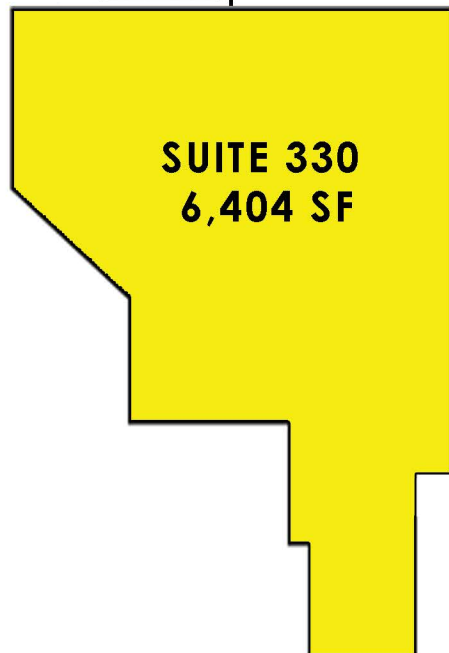

THIRD FLOOR



BULOVA CORPORATE CENTER



BULOVA CORPORATE CENTER