

BULOVA CORPORATE CENTER

75-20 ASTORIA BOULEVARD, QUEENS, NY 11370



BULOVA CORPORATE CENTER

75-20 ASTORIA BOULEVARD, QUEENS, NY 11370



AVAILABILITY

- 8,486 SF Suite 100
- 733 SF Suite 30
- 18,192 SF Suite 220
- 29,909 SF Suite 230
- 6,404 SF Suite 330
- 380 SF Suite 370

Multi-Suite Option

- 48,420 SF Suite 220/230
- 56,906 SF Suite 100/220/230

BUILDING INFORMATION

- Class A building
- On Site Parking
- Health Club
- Ping Pong Amenity
- Conference Center
- Excellent Highway Frontage
- 24 hour security
- 24/7 Public Transportation
- Access

BUILDING USES

- Office
- Medical
- Retail



RADIUS



1 MILE
3 MILE
5 MILE

POPULATION



87,655
786,705
2,649,505

AVERAGE HOUSEHOLD INCOME



\$60,225
\$60,340
\$82,401

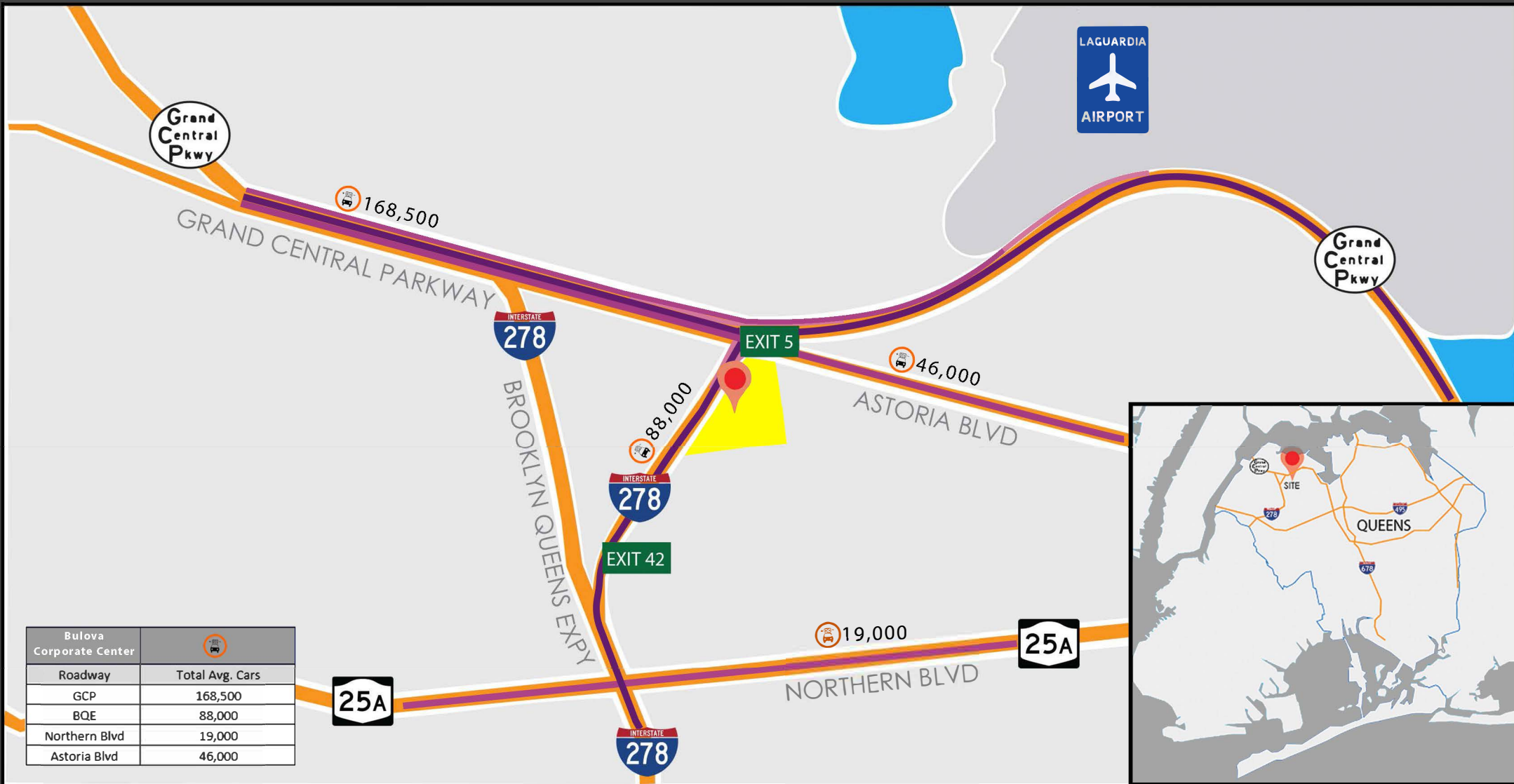

Bulova Corporate Center	
Roadway	Total Avg. Cars
GCP	168,500
BQE	88,000
Northern Blvd	19,000
Astoria Blvd	46,000



500,000 SF
CLASS A BUILDING

DENSE
MARKET



786,705 PEOPLE
IN A 3-MILE
RADIUS



HIGHWAY
ACCESS ON BQE



BULOVA CORPORATE CENTER

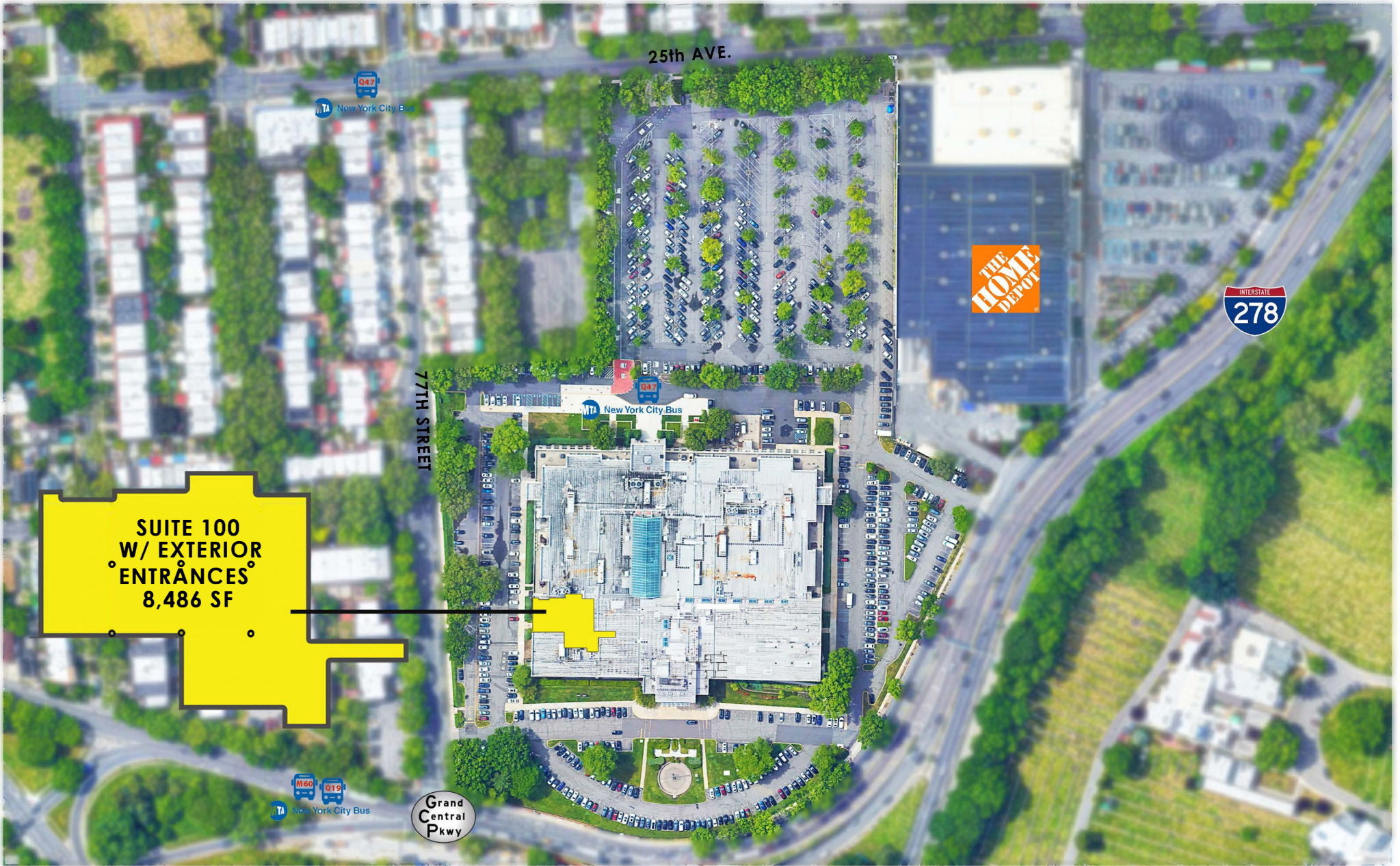

FIRST FLOOR



BULOVA CORPORATE CENTER

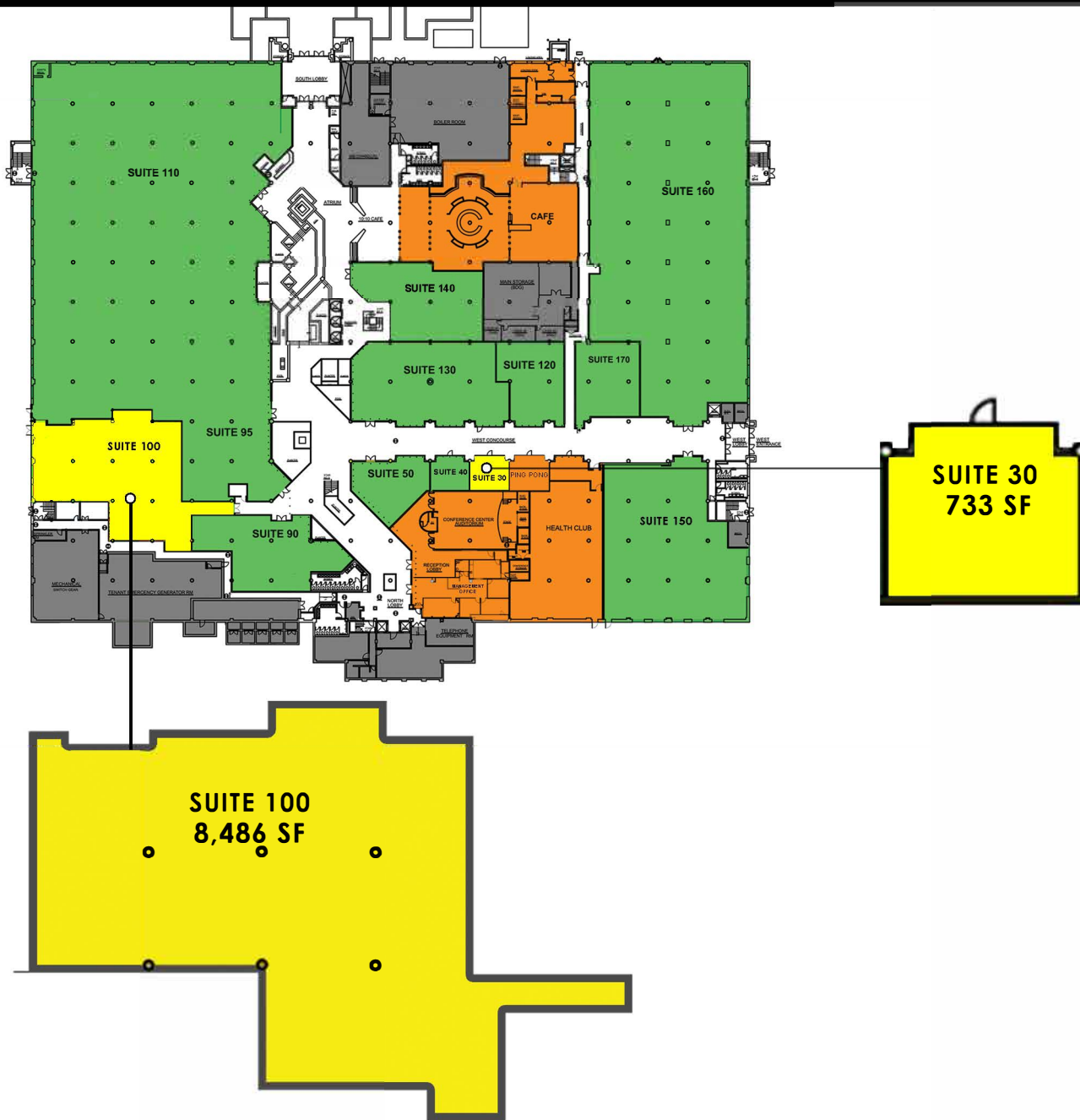

FIRST FLOOR



FIRST FLOOR RENDERING SUITE 100

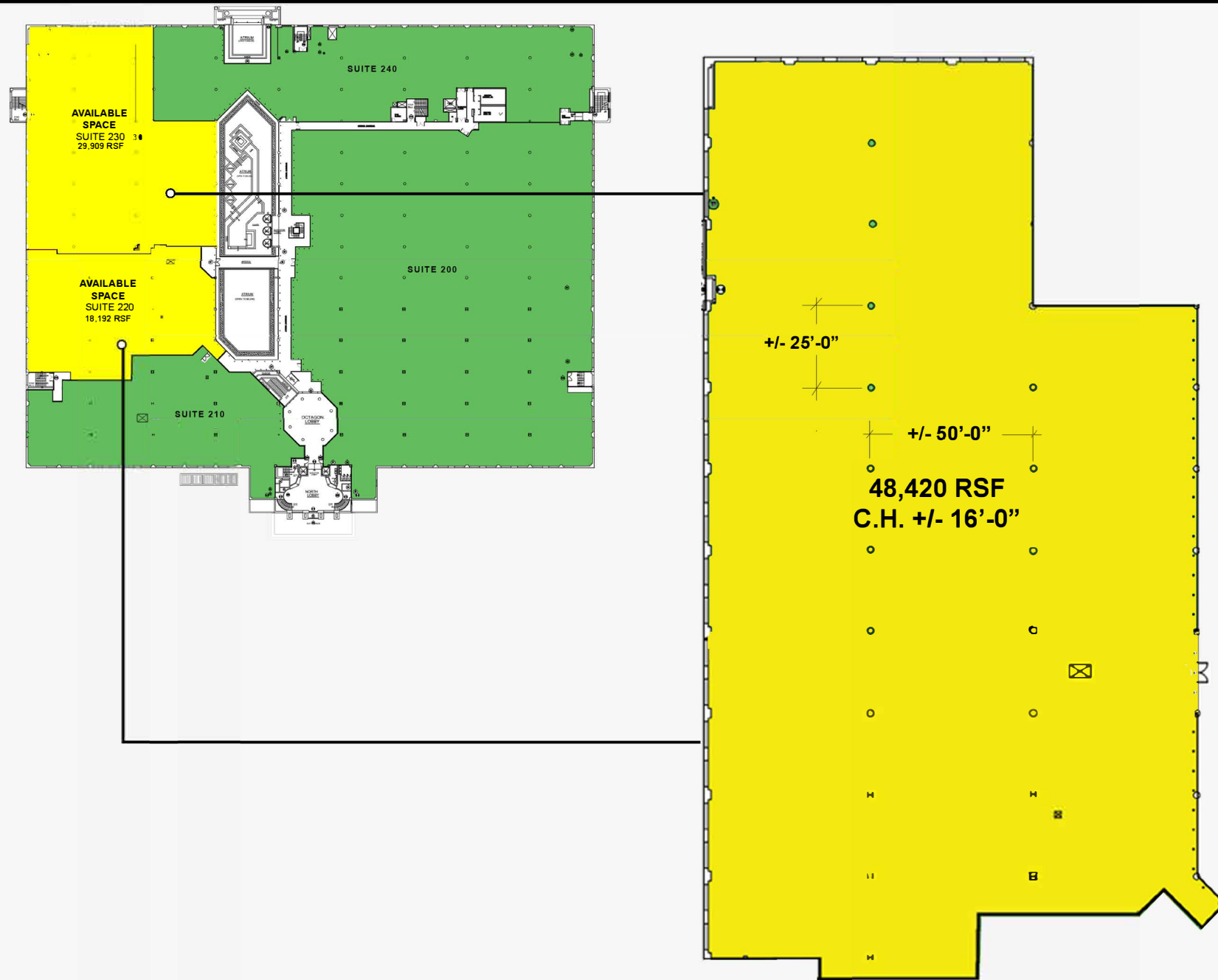

SECOND FLOOR

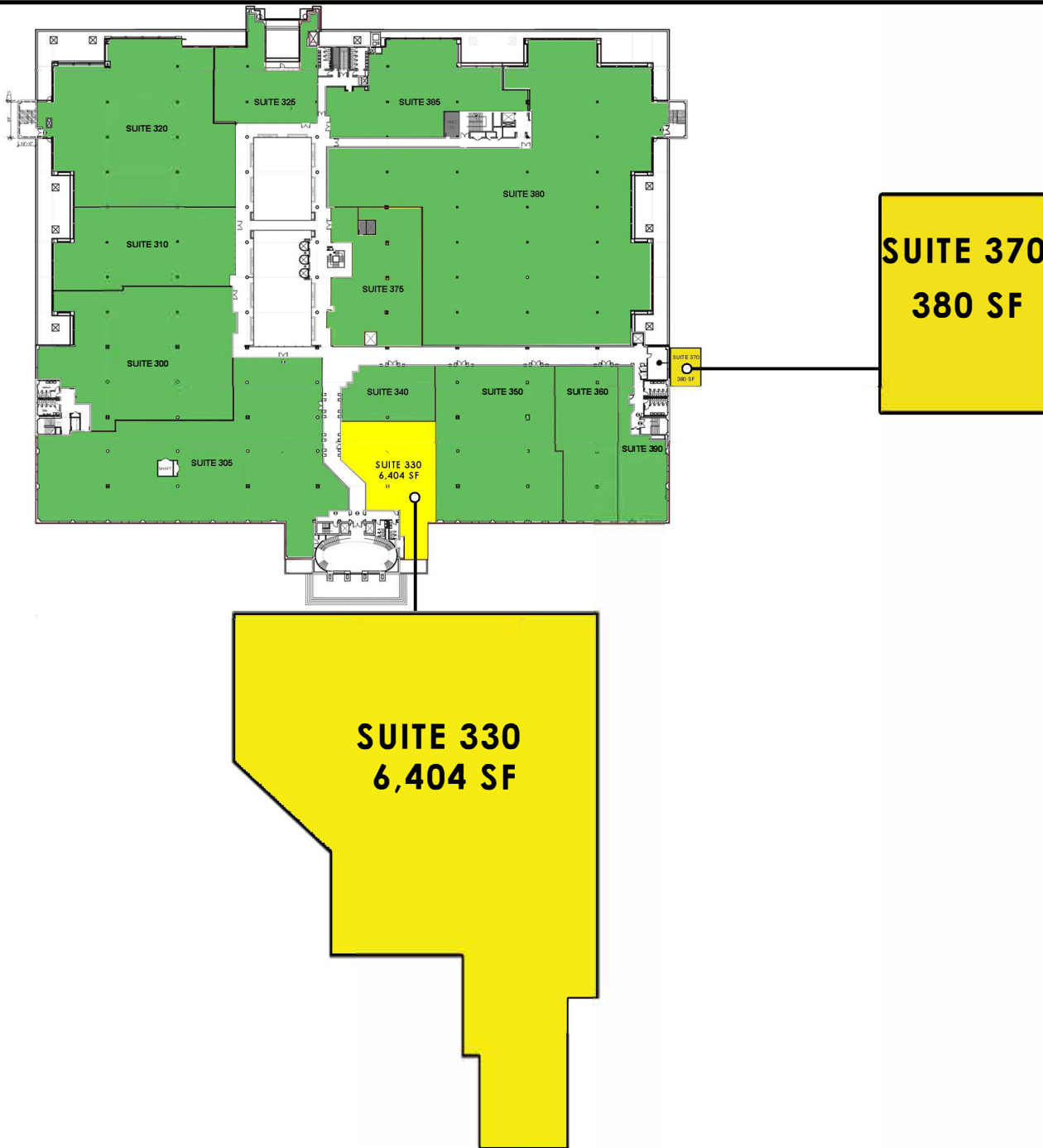

THIRD FLOOR



BULOVA CORPORATE CENTER



BULOVA CORPORATE CENTER