

# 300 ROBBINS LANE - SYOSSET, NEW YORK

+/- 2,901 SF AVAILABLE SPACE

LOCATED A QUARTER MILE NORTH OF THE LONG ISLAND EXPRESSWAY ON ROBBINS LANE SYOSSET, NY



Existing Office Building

## Property Highlights:

- Top Performing Lifetime Fitness
- +/- 2,901 sf of available space
- Across the street from the proposed 750,000 Sq. Ft. future Syosset Park
- Excellent location with LIE exposure

For more information contact:

**Brad Blumenfeld**

Phone: 516.921.0800

Fax: 516.921.0053

E-mail: [bblumenfeld@bdg.net](mailto:bblumenfeld@bdg.net)

Website: [www.bdg.net](http://www.bdg.net)



**BLUMENFELD  
DEVELOPMENT  
GROUP, LTD.**

# 300 ROBBINS LANE - SYOSSET, NEW YORK

+/- 2,901 SF AVAILABLE SPACE

LOCATED A QUARTER MILE NORTH OF THE LONG ISLAND EXPRESSWAY ON ROBBINS LANE SYOSSET, NY

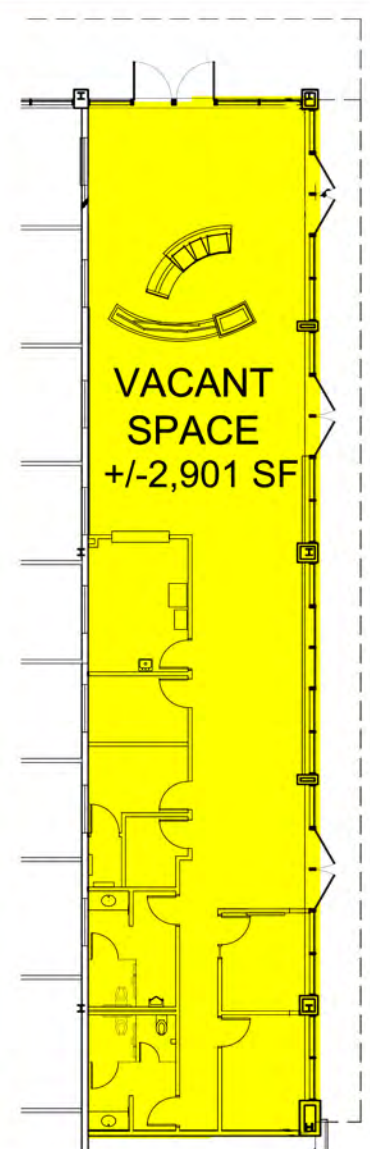

**BLUMENFELD  
DEVELOPMENT  
GROUP, LTD.**

# 300 ROBBINS LANE - SYOSSET, NEW YORK

+/- 2,901 SF AVAILABLE SPACE

LOCATED A QUARTER MILE NORTH OF THE LONG ISLAND EXPRESSWAY ON ROBBINS LANE SYOSSET, NY



300 Robbins Lane. Syosset, NY 11791  
Phone: 516.921.0800 Fax: 516.921.0053